

# Good Guys Posse Gunfight at Dry Gulch Ranch Stage 1

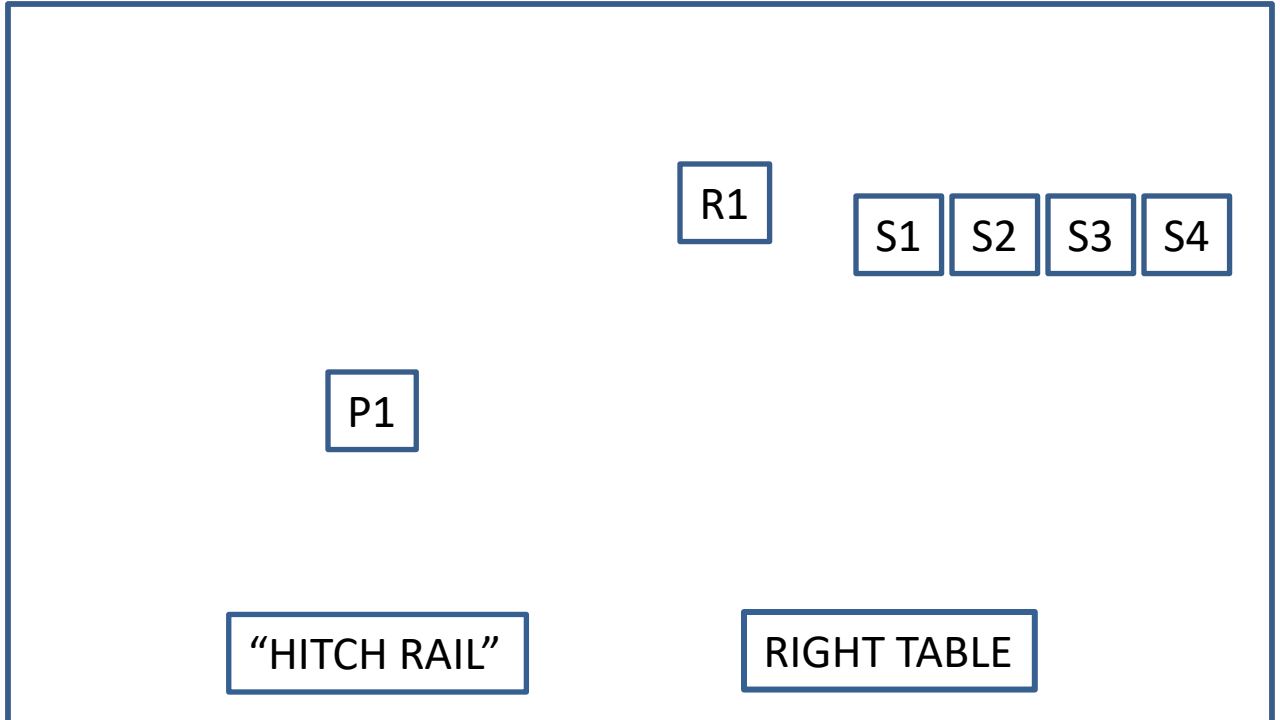

***“DOESN’T GET MUCH  
EASIER”***

**10 – Rifle  
10- Pistol  
4+ - Shotgun**



## PROCEDURE

Pistols loaded five rounds each and holstered. Rifle, ten rounds, hammer down on MT chamber and shotgun open and MT. Rifle staged on right table. Shotgun staged on right table. Starting position with hands on your hat standing in front of “HITCH RAIL”. Say the line ***“THIS WILL BE QUICK”*** ATB engage targets as follows:  
Engage the pistol target with 10 rounds. Move to the right table retrieve rifle engage rifle target with ten rounds replace rifle open and MT on table.  
Engage shotgun targets until down. Make shotgun safe.  
Proceed to unloading table.

# Good Guys Posse Gunfight at Dry Gulch Ranch Stage 2



**“NO SURPRISE HERE”**

**10 – Rifle**  
**10- Pistol**  
**4+ - Shotgun**

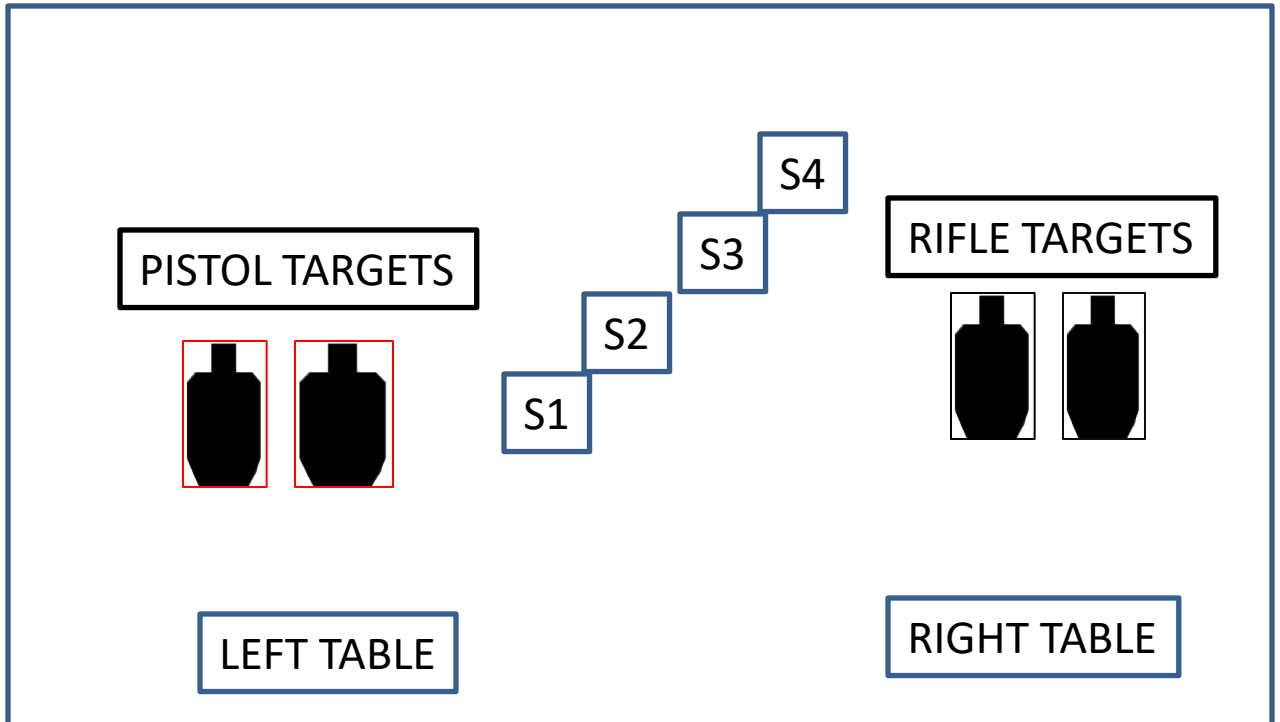

## PROCEDURE

Pistols loaded five rounds each and holstered. Rifle, ten rounds, hammer down on MT chamber staged on right table. Shotgun open and MT and staged on the right table. Starting position at left table with hands **FLAT** on the table

***Say the line “WELL GOOOLLLEE!!”***

ATB engage PISTOL targets with five bullets each **NO DOUBLE TAPS**. Move to the right table and engage the RIFLE targets as you did the PISTOL targets. Engage shotgun targets until down. Proceed to unloading table.

# Good Guys Posse Gunfight at Dry Gulch Ranch Stage 3



***“I THINK I SEE A  
PATTERN HERE”***

**10 – Rifle  
10 - Pistol  
4+ - Shotgun**

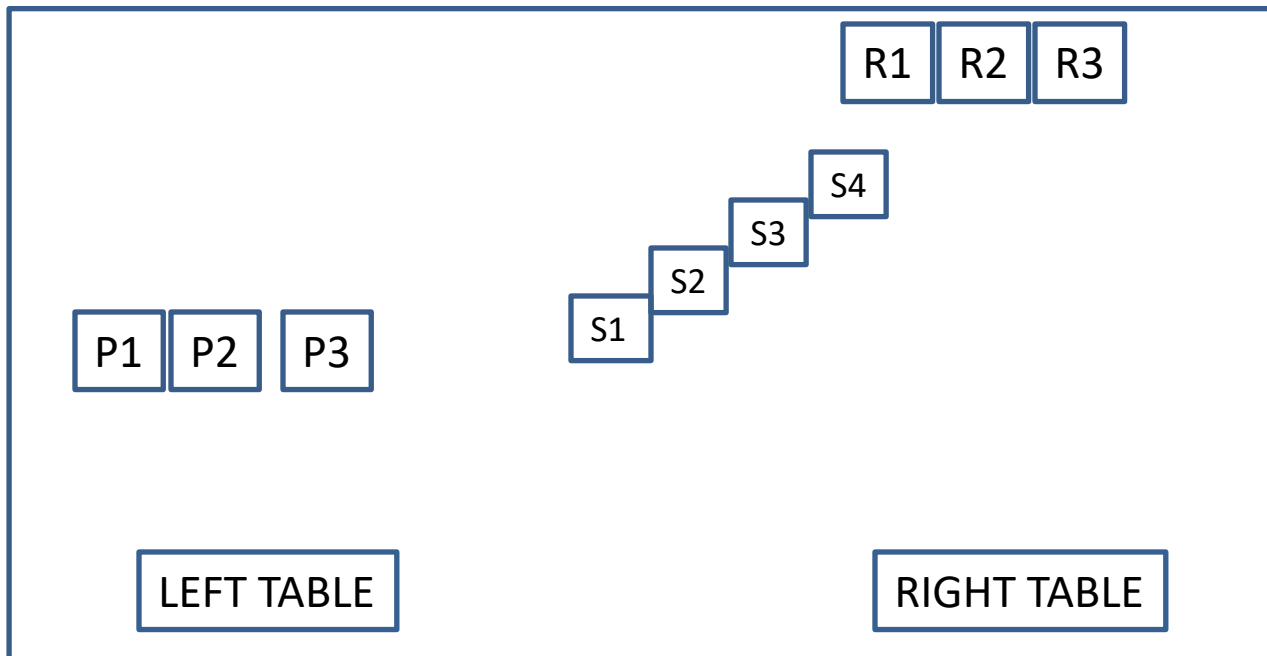

## PROCEDURE

All Shotgun Targets are engaged until down

Pistols loaded five rounds each and holstered. Rifle, ten rounds, hammer down on MT chamber and shotgun open and MT. Rifle and shotgun staged on right table. Starting position at left table. Say the line ***“I GOT THIS PILGRIM”***

ATB engage targets as follows:

Draw one or both pistols and engage targets from EITHER DIRECTION in a **JOHN WAYNE SWEEP** (l-r 1-2-3-3-2-1-1-2-3-3 or r-l 3-2-1-1-2-3-3-2-1-1). Holster pistols. Move to the right table engage rifle targets in the same direction as pistol targets. Restage rifle open and MT. Pick up shotgun and engage targets in any order until down. Make shotgun safe. Proceed to unloading table.

# Good Guys Posse Gunfight at Dry Gulch Ranch Stage 4



***“YEP THERE’S A  
PATTERN”***

**10 – Rifle  
10- Pistol  
4+ - Shotgun**

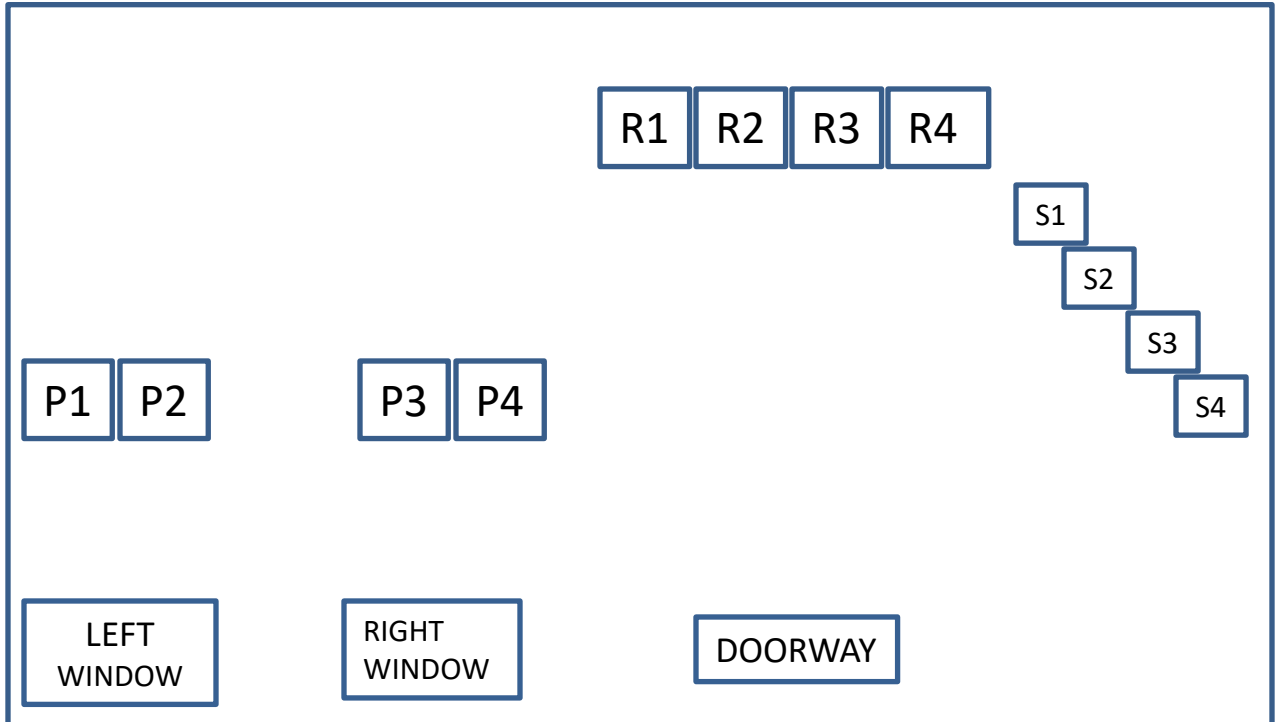

## PROCEDURE

All Shotgun Targets are engaged until down.

Pistols loaded five rounds each and holstered. Rifle, ten rounds, hammer down on MT chamber and shotgun open and MT. Rifle and shotgun staged on doorway table. Starting position at left window. Say the line ***“THIS IS DIFFERENT”*** ATB engage targets as follows:

Draw one pistol and engage targets in a **DRY GULCH SWEEP**( 1-2-1-2-1). Holster pistol. Move to the RIGHT WINDOW and continue the **DRY GULCH SWEEP** (3-4-3-4-3) holster pistol. Move to the DOORWAY and engage rifle targets in the same order as pistol targets. Restage rifle open and MT. Pick up shotgun and engage targets in any order until down. Make shotgun safe. Proceed to unloading table.

# Good Guys Posse Gunfight at Dry Gulch Ranch Stage 5



**“THIS IS EASY”**

**10 – Rifle**  
**10 - Pistol**  
**4+ - Shotgun**

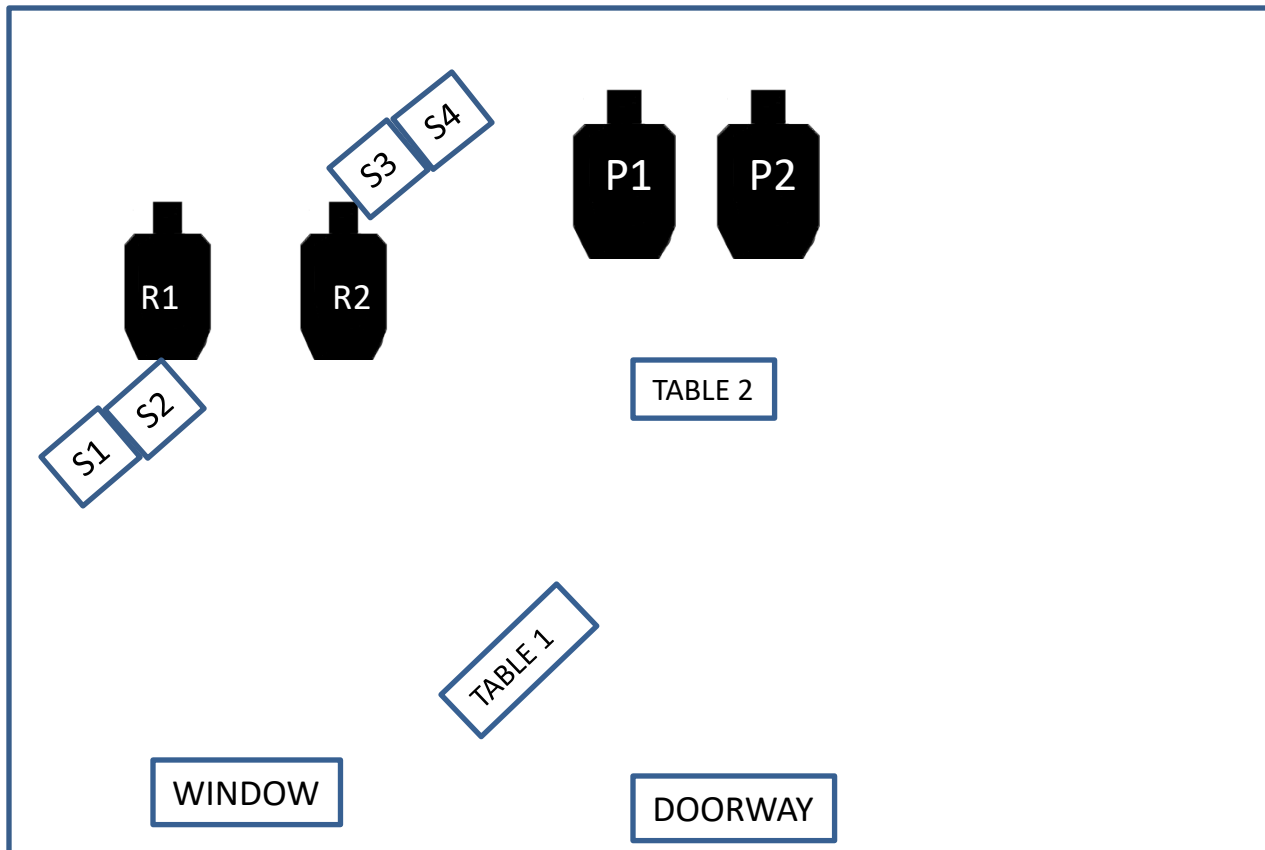

## PROCEDURE

All Shotgun Targets are engaged until down

Pistols loaded five rounds each holstered. Rifle, ten rounds, hammer down on MT chamber. Shotgun open and MT staged on Table 1. Starting position at window with rifle at the ready. Say the line **“This is easy”**  
ATB engage targets with rifle in a **DOUBLE TAP SWEEP** the rifle targets from **either direction**. Move to table 1 and place rifle on table pick up shotgun and engage S1 and S2 until down then move to table 2, you may move with shotgun closed on **SPENT ROUNDS**. Restage shotgun open and MT on table 2 and engage pistol targets in a **DOUBLE TAP SWEEP** from **either direction**. Retrieve shotgun and engage S3 and S4. Make shotgun safe. Proceed to unloading table.

# Good Guys Posse Gunfight at Dry Gulch Ranch Stage 6



## ***“Withdrawal”***

S1 is a knockdown  
S2 is a swinger

0 – Rifle  
0- Pistol  
8+ - Shotgun

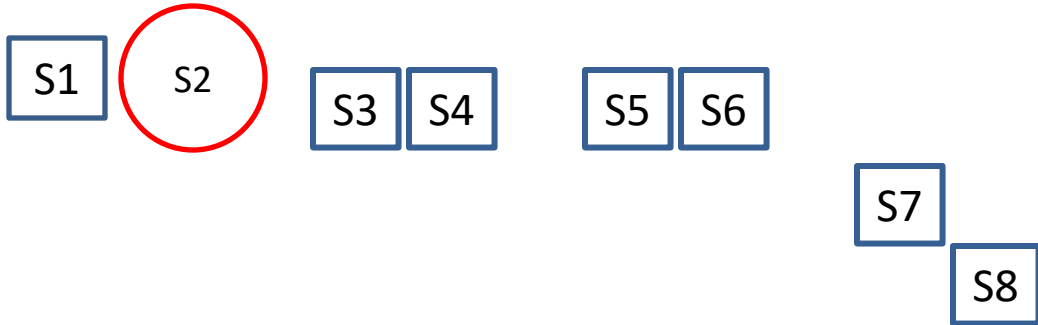

TABLE

WINDOW

DOORWAY

WINDOW

### PROCEDURE

**All Shotgun Targets are engaged until down.**

STAGING TABLE

Shotgun open and empty staged on table in doorway. Shells must be taken from the body and all shots must be fired from the boardwalk. No ammunition in receiver until in position. With hands on your belt at the STAGING TABLE say the Line: ***“I’m closing out your accounts”***  
ATB: Starting from the staging table pick up two bags of gold carry to doorway place bags on table retrieve shotgun shoot four center targets from doorway and two targets from each window. Shotguns shall remain unloaded with an empty carrier until the shooter is stationary at the shooting position. Show open and empty shotgun to timer operator.